

# Battery discharge display POWERGAUGE

## BATTERY DISCHARGE DISPLAY

The PowerGauge is a comprehensive range of Battery Discharge Indicators to maximize the productivity of your vehicle and minimize the potential for damage from operating outside the batteries optimum parameters. The development of this product range has been a result of close collaboration with customers, maintenance engineers and battery experts.

## FEATURES

- Industry standard package (52mm)
- Microprocessor controlled
- Automatic reset
- Partial recharge recognition and indication
- 10 segment LED display
- Reverse polarity protection
- LCD hours count
- Lockout relay
- Discharge curve selector



## SOLID-STATE DISPLAY

All the PowerGauge products are microprocessor based with no moving parts, maximizing reliability. The super bright 10 segment LED bar graph gives instant battery state of charge feedback under all light conditions.

## OPPORTUNITY PARTIAL RECHARGE RECOGNITION

The superior monitoring algorithms are able to track battery state of charge following opportunity partial recharges irrespective of if the Powergauge remains connected during the charging process.

## KEY PARAMETERS

Op. Voltage +25%	24 VDC	36 VDC	48 VDC
Max. consumption	35 mA	35 mA	25 mA
LCD Display	6 digits, numeral size 4.5 mm		
LCD Displays	10 (5 green, 3 yellow, 2 red)		
Counting range	0-99999.9 h		
Partial recharges	are displayed		
Relay contact	Voltage free, opens when reaching discharge voltage		
Switching capacity	5 A	3 A	3 A
Relay restart	After relay cutoff one single restart for 30 s possible		
Signal input	Min. pulse time 0.5 s		
Weight, approx.	100 g		
Connector	8 - pole Molex Mini-fit Junior		
Protection class	IP65		

## LOW VOLTAGE CUT-OUT

An internal relay provides a cut-out at 80% discharge. This can operate warning alarms or disable functions such as lift pump motors.

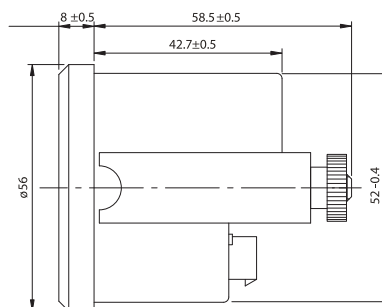

HSCT b.v.  
Melkrijder 9  
3861 SG Nijkerk  
The Netherlands

T. +31 (0)33 25 70811  
F. +31(0)33 25 70812

E. [info@hsct.nl](mailto:info@hsct.nl)  
I. [www.hsct.nl](http://www.hsct.nl)